



TAYLOR PITTSBURGH MFG.
PO BOX 1200
WINFIELD, AL 35594
423-745-3110

TAYLOR WAY

SERIES 233

ATV - IMPLEMENTS

for

MODELS

233-14-10-CD Compact Disc
233-14-14-CD Compact Disc
233-16-8-CDF Flip Over Disc
233-CP-48-ATV Culti-Packer

OWNERS MANUAL

Form 233-ATV-SC
February 2016

TABLE OF CONTENTS

WARRANTY.....	1
SAFETY SYMBOLS & SIGNAL WORDS.....	2
GENERAL INFORMATION.....	3
BOLT TORQUE CHART.....	3
SPECIFICATIONS.....	4
SAFETY RULES.....	5-6
SAFETY DECALS & LOCATIONS.....	7
INTRODUCTION.....	8
ASSEMBLY.....	8
BEFORE OPERATION.....	8
OPERATION.....	9
ATTACHING.....	9
TRANSPORTING.....	9
ADJUSTMENTS.....	9
MAINTENANCE.....	9
STORAGE.....	9
33" COMPACT DISC COMPONENTS.....	10
48" COMPACT DISC COMPONENTS.....	11
FLIP OVER DISC COMPONENTS.....	12
CUTIPACKER COMPONENTS.....	13

TO THE DEALER:

The Implement assembly and proper installation to the tractor is the responsibility of the TAYLOR PITTSBURGH dealer. Read manual instructions and safety rules. Make sure all items on the Pre-delivery and Delivery Check Lists are completed before releasing equipment to the owner.

TO THE OWNER:

Read this manual before operating your TAYLOR PITTSBURGH rear blade. The information presented will prepare you to do a better and safer job. Keep this manual handy for ready reference. Require all operators to read this manual carefully and become acquainted with all the adjustment and operating procedures before attempting to operate. Replacement manuals can be obtained from your dealer or by calling 1-423-745-3110, in the USA and Canada only.

The rear blade you have purchased has been carefully engineered and manufactured to provide dependable and satisfactory use. Like all mechanical products, it will require cleaning and upkeep. Lubricate the unit as specified. Observe all safety information in this manual and safety decals on the rear blade and tractor.

For service, your authorized TAYLOR PITTSBURGH dealer has trained mechanics, genuine TAYLOR PITTSBURGH service parts, and the necessary tools and equipment to handle all your needs.

Provide this information to your dealer to obtain correct repair parts.

LIMITED WARRANTY

TAYLOR PITTSBURGH MFG., INC., the manufacturer, warrants only to the Original Purchaser that this equipment, under normal use and service, will be free from defects in material and workmanship for one (1) year from date of purchase providing this equipment is purchased for individual and not for commercial use. Warranty for commercial usage is 90 days. This warranty does not apply to any equipment which has been damaged or which has been subjected to abuse, misuse, negligence, abnormal wear and tear, alterations, tampering, or failure to follow operating instructions. This warranty does not cover any product or parts not manufactured by Taylor Pittsburgh Manufacturing, Inc..

Under this warranty, the manufacturer will repair or replace any part which the manufacturer determines has failed during the period of the warranty due to defects in material or workmanship. After approval by the manufacturer, the equipment or defective part must be returned to Taylor Pittsburgh Mfg., Inc., Athens, Tennessee 37371.

PURCHASER'S EXCLUSIVE REMEDY FOR BREACH OF WARRANTY, OTHER DEFECT, OR CONDUCT GIVING RISE TO LIABILITY SHALL BE THE REPAIR OR REPLACEMENT OF THE PRODUCT SOLD, AND THE MANUFACTURER UNDER NO CIRCUMSTANCES SHALL BE LIABLE FOR ECONOMIC LOSS OR INCIDENTAL OR CONSEQUENTIAL DAMAGES. THE MANUFACTURER DISCLAIMS ALL IMPLIED WARRANTIES, INCLUDING THE WARRANTY OF MERCHANTABILITY AND FITNESS FOR PURPOSE.

Taylor Pittsburgh Mfg., Inc. reserves the right to make improvements and changes in specifications without notice or obligation to modify previously sold units.

This manual describes the proper assembly procedures for your rear blade and furnishes operating and maintenance recommendations to help you obtain long and satisfactory service.

SAFETY RULES



ATTENTION! BECOME ALERT! YOUR SAFETY IS INVOLVED!



SAFETY ALERT SYMBOL

FIG. 1: This is the safety alert symbol. It means **ATTENTION: BECOME ALERT! YOUR SAFETY IS INVOLVED!** Look for it, both in this manual and on safety decals on the equipment. It will direct your attention to information that involves your safety and the safety of others.



Figure 1

SIGNAL WORDS

FIG. 2: The words **DANGER**, **WARNING** or **CAUTION** are used with the safety alert symbol. Learn to recognize these safety alerts, and follow the recommended precautions and safe practices.

 **DANGER:** The safety alert symbol, with the word **DANGER**, indicates an imminently hazardous situation that, if not avoided, will cause **DEATH OR VERY SERIOUS INJURY**.

 **WARNING:** The safety alert symbol, with the word **WARNING**, indicates a potentially hazardous situation that, if not avoided, could cause **DEATH OR SERIOUS INJURY**.

 **CAUTION:** The safety alert symbol, with the word **CAUTION**, indicates a potentially hazardous situation that, if not avoided, may cause a **MINOR INJURY**.



Figure 2

Replace any **DANGER**, **WARNING**, **CAUTION** or instructional decal that is not readable or is missing. The location and part number of these decals is identified later in the section of the manual.

IMPORTANT: The word **IMPORTANT** is used to identify special instructions or procedures which, if not strictly observed could result in damage to, or destruction of the machine, process or its surroundings.

GENERAL INFORMATION

READ THIS MANUAL carefully to learn how to properly operate and service your implement correctly. Failure to do so could result in personal injury or equipment damage.

Throughout this manual references are made to right and left direction. **RIGHT - HAND AND LEFT - HAND** sides are determined by standing behind the unit facing the direction the implement will travel when going forward.

The purpose of this manual is to assist you in operating and maintaining your implement. It will furnish **important** information and instructions that will help you achieve years of dependable performance. These instructions have been compiled from extensive field experience and engineering data. Some information may be general in nature due to unknown and varying operating conditions.

However, through experience and these instructions, you should be able to develop procedures suitable to your particular situation. Maintain your implement with original equipment repair parts to optimum performance.

The illustrations and data used in this manual were current at the time of printing, but due to possible production changes, your machine may vary slightly in detail. We reserve the right to redesign and change the machines as may be necessary without notification.

BOLT TORQUE CHART

GRADE 2

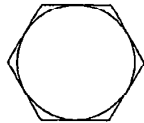

GRADE 5



GRADE 8

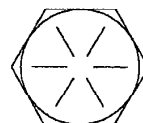

TORQUE IN FOOT POUNDS (NEWTON METERS)

BOLT SIZE	3/8	1/2	5/8	3/4	7/8	1	
HEX HEAD	9/16	3/4	15/16	1-1/8	1-5/16	1-1/2	
GRADE	2	18 (24.4)	45 (61.0)	89 (120.7)	160 (216.9)	252 (341.6)	320 (433.9)
	5	30 (40.6)	68 (92.2)	140 (189.8)	240 (325.4)	360 (488.1)	544 (737.5)
	8	40 (54.2)	100 (135.6)	196 (265.7)	340 (460.9)	528 (715.1)	792 (1073.8)

SPECIFICATIONS

MODEL	233-14-10-CD Compact Disc	233-14-14-CD Compact Disc	233-16-18-CDF Flip Over Disc	233-CP-48-ATV Cultipacker
Cutting Width - in. (mm)	36 (914)	48" (1221.3)	48" (1221.3)	48" (1221.3)
Max. Cutting Depth - in. (mm)	6 (152)	6 (152)	6 (152)	-----
Hitch Type	1-7/8" Ball Coupler	1-7/8" Ball Coupler	1-7/8" Ball Coupler	1-7/8" Ball Coupler
Garden Tractor HP (ATV-cc)	14 - 20 (350cc)	14 - 20 (450cc)	14 - 20 (350cc)	14 - 20 (350cc)
Number of Discs	10	14	8	20 Wheels
Disc Blade Spacing - in. (mm)	7-1/2" (190.5)	7-1/2" (190.5)	7-1/2" (190.5)	-----
Disc Blade Diameter-in. (mm)	14" (355.8)	14" (355.8)	16" (407.1)	9-1/2" X 2-1/4" Wheel
Angling (Degrees)	7-1/2 (F) - 8-3/4 (R)	7-1/2 (F) - 8-3/4 (R)	20	-----
Blade Material	Heat Treated High Carbon Steel	Heat Treated High Carbon Steel	Heat Treated High Carbon Steel	Cast Iron
Frame Type - in. (mm)	2" (50.8)	2" (50.8)	3" (76.3)	3/16" (4.7)
Gang Type - in. (mm)	2" (50.8)	2" (50.8)	3" (76.3)	3/16" (4.7)
Gang Axles - in. (mm)	1" (25.4)SQ. High Carbon Steel	1" (25.4)SQ. High Carbon Steel	1" (25.4)SQ. High Carbon Steel	Beater Bar 1-3/4" (44.5)
Bearing Type / Flanged	Maintenance Free	Maintenance Free	Maintenance Free	Maintenance Free
Leveling	Adjustable Link	Adjustable Link	Free Floating	Free Floating
Tires/Transport	Pneumatic	Pneumatic	Pneumatic	Pneumatic
Depth Control/Transport	Manually Adjustable	Manually Adjustable	Non-Adjustable	Non-Adjustable
Approx. Weight - lbs. (kg)	225 (102)	350 (159)	319 (144.6)	310 (140.5)
Approx. Weight per Blade	22.5 (10.2)	35.0 (15.9)	39.8 (18)	15.5 (7)

SAFETY RULES



ATTENTION! BECOME ALERT! YOUR SAFETY IS INVOLVED!



Your personal safety is a primary concern in the design and manufacture of our products. Our efforts to provide safe equipment can be wiped out by a single careless act of an operator.

In addition to the design and configuration of equipment, hazard control and accident prevention are dependent upon the awareness, concern, prudence and proper training of personnel involved in the operation, transport, maintenance and storage of equipment.

It has been said "The best safety device is an informed, careful operator." We ask you to be that kind of an operator.

The design of this equipment depends on it being operated within the limitations as explained in this manual.

TRAINING

- Safety instructions are important! Read this manual and the tractor manual; follow all safety rules and safety decal information. (Replacement manuals are available from dealer.) Failure to follow instructions or safety rules can result in serious injury or death.
- If you do not understand any part of this manual and need assistance, see your dealer.
- Know your controls and how to stop engine and attachment quickly in an emergency.
- The operator must be instructed in and be capable of the proper operation of the equipment, its attachments and all controls. Do not allow anyone to operate this equipment without proper instructions.
- Do not allow children or untrained persons to operate equipment.

PREPARATION

- Always wear close fitting clothing and personal protection equipment called for by the job conditions. These items may include a hard hat, safety glasses, goggles or face shield, hearing protection and safety boots. DO NOT wear loose clothing, jewelry or any other items that may be entangled in moving parts. Tie up long hair.

- Ensure implement is properly mounted, adjusted and in good operating condition.
- Tighten all bolts and nuts and check that all cotter pins are installed securely to ensure equipment is properly assembled before operating.
- Remove accumulated debris from this equipment, tractor and engine to avoid fire hazard.
- Ensure all safety decals are installed. Replace if damaged. (See Safety Decals section for location.)

OPERATIONAL SAFETY

- Keep bystanders away from equipment while it is in operation.
- Operate only in daylight or good artificial light.
- Always comply with all state and local lighting and marking requirements.
- Use caution when working around sharp objects such as disc blades, tines, etc.
- No riders are allowed on equipment.
- Always sit in tractor seat with seat belt fastened when operating controls or starting engine. Place transmission in park or neutral, engage brake and ensure all other controls are disengaged before starting tractor engine.
- Look down and to the rear and make sure area is clear before operating in reverse.
- Do not operate on steep slopes.
- Do not stop, start or change directions suddenly on slopes.
- Use extreme care and reduce ground speed on slopes and rough terrain.
- Watch for hidden hazards on the terrain during operation.

(Safety Rules continued on following page)

SAFETY RULES



ATTENTION! BECOME ALERT! YOUR SAFETY IS INVOLVED!



(Safety Rules continued from previous page)

- Stop tractor and implement immediately upon striking an obstruction. Turn off engine, remove key, inspect and repair any damage before resuming operation.
- When performing any service or maintenance, disengage power to implement. Lower all raised components to the ground. Stop engine, set parking brake and remove key before dismounting tractor.

MAINTENANCE SAFETY

- Before working underneath, raise implement to highest position and block securely. Blocking up prevents implement dropping from hydraulic leak down, hydraulic system failures, or mechanical failure on the tractor.
- Keep all persons away from operator control area while performing adjustments, service or maintenance.
- Frequently check blades. They should be sharp, free of nicks and cracks and securely fastened.
- Do not handle blades with bare hands. Careless or improper handling may result in serious injury.
- Your dealer can supply genuine replacement blades. Substitute blades may not meet original equipment specifications.

TRANSPORTING SAFETY

- Use a Slow-Moving-Vehicle (SMV) emblem and proper lighting on the tractor when transporting the implement .
- Do not transport implement over 10 MPH (15 KPH) on the best surface conditions. Reduce speed when approaching ditches or corners.
- Always comply with all state and local lighting and marking requirements.
- Raise implement to highest position for transport.
- Keep implement in proper working condition. Unauthorized modifications to the implement may impair the function, implement life, and put you at risk. Do not add excessive weight to implement.

Additional weight could cause frame to fall resulting in loss of control of implement / tractor during transport.

- Watch low hanging Overhead Power Lines during transport. Avoid contact as this can cause serious injury or death.

STORAGE

- Lower implement to the ground for storage and block to prevent rolling.
- Store on a level surface sheltered from the weather.
- Coat soil engaging surfaces with a rust inhibitor after cleaning.
- Keep playing children and bystanders away from storage area.

SAFETY DECALS



ATTENTION! BECOME ALERT! YOUR SAFETY IS INVOLVED!
Replace Immediately If Damaged!



DECAL LOCATIONS

The following safety decals are located on your implement. Read them and follow their instructions. Keep all decals in place and legible. Replace worn or missing decals. Replacement safety decals are available through your dealer. Order by number listed.



CAUTION

**READ YOUR OWNERS MANUAL
USE SAFE OPERATING PRACTICES
MAX. TRANSPORT SPEED - 10 MPH**

ON FRONT CROSS MEMBER OF FRAME

INTRODUCTION

This manual covers the assembly, operation, and maintenance of your Series 233 ATV implement. Studying and obeying these instructions will insure optimum product performance and longevity. Be sure to read all instructions carefully. Read all safety precautions prior to operation.

Maintain your implement with original repair parts to insure optimum performance.

MODIFICATIONS

It is the policy of the manufacturer to improve its products whenever possible and practical. We reserve the right to make changes, improvements, and modifications at any time without incurring the obligation to make such changes, improvements, and modifications on any implement sold previously.

ASSEMBLY

General

Your Series ATV Disc Harrow is shipped completely assembled except for the leveling link. Connect to leveling link to top lug of harrow frame with 5/8 X 3 bolt and locknut provided. Use flatwashers with slotted holes. Always use lockwashers unless a lock nut is called for. Tighten hardware after parts are installed according to the torque chart given. Unless otherwise stated, all hardware is Grade 5. The following assembly steps are given to minimize the need for adjustment after assembly. Remember that **LEFT** and **RIGHT** are determined by standing at the rear of the implement and facing it.

BEFORE OPERATION

- 1) Tighten all loose hardware using the torque chart. **SEE ASSEMBLY.** Replace any missing hardware. On new machines, all hardware must be rechecked after first few hours of operation.
- 2) Replace any bent or broken parts.
- 3) Refer to your Owner's Manual for recommended adjustments and weight distribution on towing vehicle.
- 4) Read the **SAFETY** section of this manual to be sure of all precautions.

OPERATION

Your personal safety is a primary concern in the design and manufacture of our products. Unfortunately, our efforts to provide safe equipment can be wiped out by a single careless act of an operator.

In addition to the design and configuration of equipment, hazard control and accident prevention are dependent upon the awareness, concern, prudence and proper training of personnel involved in the operation, transport, maintenance and storage of equipment.

It has been said **"The best safety device is an informed, careful operator."** We ask you to be that kind of an operator.

The operator is responsible for the proper operation of this disc harrow. The operator must be properly trained. Operators should be familiar with the disc harrow and tractor and all safety practices before starting operation. Read the safety information on pages 5 through 6.

ATTACHING

- 1) Back tractor to align 1-7/8" diameter ball with female ball coupler on hitch.

WARNING

Be sure bystanders are clear. Do not stand between harrow and tractor. Shut off tractor and engage parking brake prior to dismounting.

- 2) Latch coupler link.

TRANSPORTING

- 1) Transport implement lifted high above ground.
- 2) Travel at a speed suitable for terrain and other conditions. Transport at speeds compatible with safety and no more than 10 MPH (15 KPH). Use care when transporting on rough terrain.
- 3) Avoid night travel on public roads. If unavoidable, be sure to use adequate lighting on tractor and implement. Always have a Slow Moving Vehicle (SMV) emblem attached to the implement clearly visible from the rear. Check local laws regarding transport on public roads.

ADJUSTMENTS

Front To Rear Leveling

The harrow is leveled front to rear by adjusting the length of the leveling link between the tongue and the harrow frame. Shorten the link to tilt the harrow forward, and lengthen the link to tilt the harrow backward.

MAINTENANCE

Before Each Use

- 1) Your Series 233 implement is equipped with triple lipped sealed bearings which do not require lubrication.

- 2) Check over entire implement to see that all bolts are in place and tight.

After First Few Hours of Use

The disc gangs are torqued at the factory but can become loose during the first use as they seat themselves. Because of this it is necessary to check the disc blades to see they are tight. Do this by lightly striking each blade with a hammer. If a ringing sound is heard, the blade is tight. If a flat sound is heard, the blade is loose and the gang should be retorqued. Do this by removing the cotter pin from the gang bolt nut and torquing the bolt to 500 ft-lbs (667.9 N.m).

STORAGE

- 1) Clean all dirt and debris from implement prior to storage.
- 2) Store implement on a flat surface sheltered from the weather.
- 3) Lower implement to the ground and block to prevent rolling.
- 4) For periods of long storage, coat soil engaging surfaces with a rust inhibitor such as grease or oil. Apply touch-up paint to frame where paint is worn or chipped to prevent rusting.

233 COMPACT DISC

Item	Part #	Description	Qty
1	930250	MAIN FRAME WELDMENT	1
2	930263	PLASTIC CAP	7
3	930266	WHEEL CARRIAGE	1
	303957	LOCKWASHER 3/4"	4
	304109	COTTER PIN 3/16" X 1-1/2"	2
4	930260	PNEUMATIC WHEEL & TIRE	2
5	303681	HHCS 5/8" X 3-1/2"	3
	304021	LOCKNUT 5/8"	3
6	930267	PULL TONGUE	1
7	930257	TURNBUCKLE	1
8	303620	HHCS 3/8" X 3"	2
	304018	LOCKNUT 3/8"	2
9	930258	BALL HITCH 1-7/8"	1
10	303680	HHCS 5/8" X 3"	1
	304021	LOCKNUT 5/8"	1
11	930255	JACK (Top Wind)	1
	303655	HHCS 1/2" X 2-1/2"	1
	304020	LOCKNUT 1/2"	1

MAIN FRAME COMPONENTS

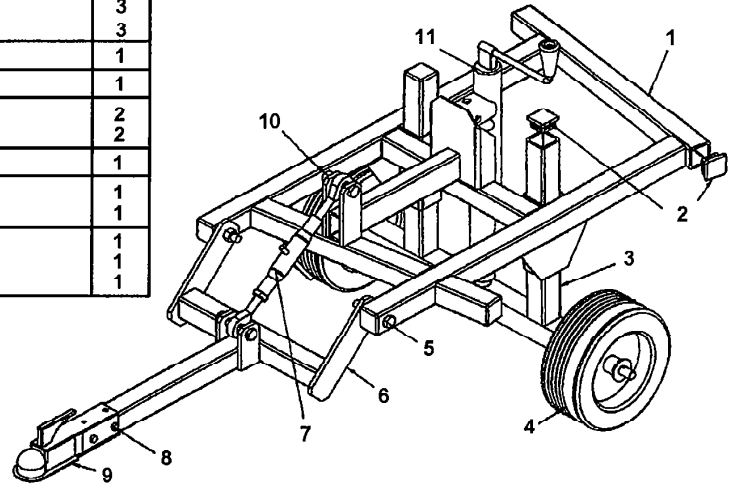

DISC GANG COMPONENTS

Item	Part #	Description	Qty
1	304024	LOCKNUT 1"	1
2	930268	ENDWASHER	2
3	930265	SHORT SPACER 3" Long	8
4	303859	CARR. BOLT 1/2" X 1-1/2"	8
	303955	LOCKWASHER 1/2"	8
	304007	HEX NUT 1/2"	8
5	607727	SEALED BRG. 1" Sq.	4
6	930254	BRG. HANGER	4
7	930264	LONG SPACER 7-1/4" Long	4
8	930256	C.O. DISC 14"	10
9	930269	AXLE 1" Sq.	2
10	930259	U-BOLT 1/2" X 3"	4
	304007	HEX NUT 1/2"	8
	303955	LOCKWASHER 1/2"	8

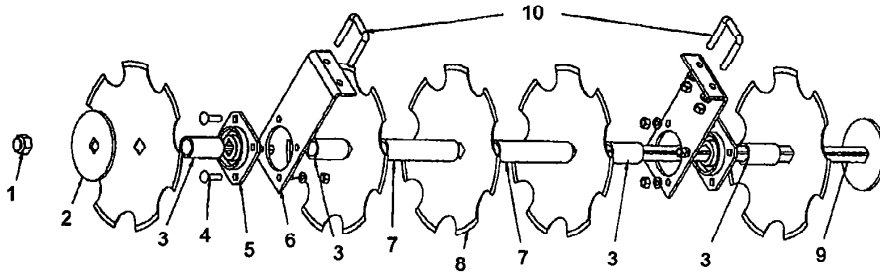

233-14-14-CD COMPACT DISC

Item	Part #	Description	Qty
1	930280	PNEUMATIC WHEEL & TIRE	2
2	930263	PLASTIC CAP	7
3	401033	AXLE 1" Sq. X 46-3/4"	2
4	607727	SEALED BRG. 1" Sq.	4
5	930259	U-BOLT 1/2" X 3"	4
	304007	HEX NUT 1/2"	8
	303955	LOCKWASHER 1/2"	8
6	304024	LOCKNUT 1"	4
7	303973	FLAT WASHER 3/4"	1
	304109	COTTER PIN 3/16" X 1-1/2"	1
8	930256	C.O. DISC 14"	14
9	930257	TURNBUCKLE	1
10	930254	BRG. HANGER	1
11	930255	JACK (Top Wind)	1
	303655	HHCS 1/2" X 2-1/2"	1
	304020	LOCKNUT 1/2"	1
12	930258	BALL HITCH 1-7/8"	1
13	930264	LONG SPACER 7-1/4" Long	4
14	930265	SHORT SPACER 3" Long	8
15	930268	ENDWASHER	2

MAIN FRAME COMPONENTS

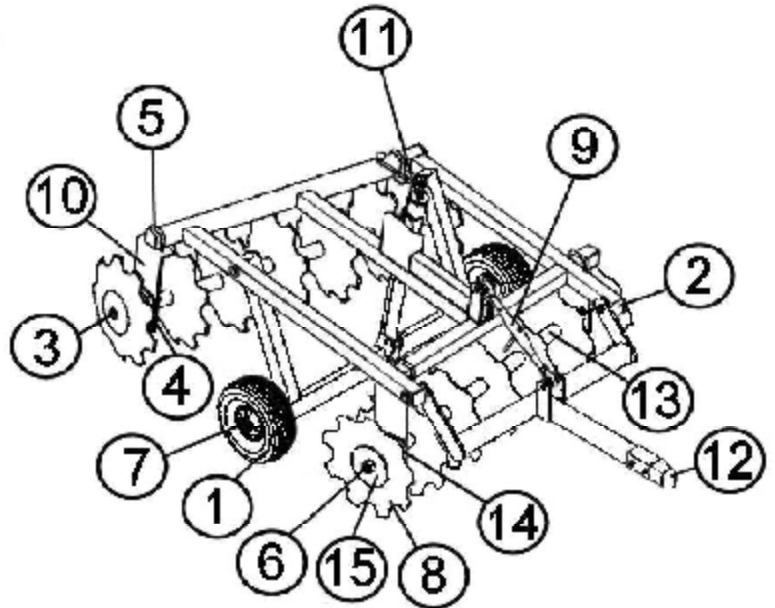

DISC GANG COMPONENTS

Item	Part #	Description	Qty
1	304024	LOCKNUT 1"	1
2	930268	ENDWASHER	2
3	930265	SHORT SPACER 3" Long	8
4	303859	CARR. BOLT 1/2" X 1-1/2"	8
	303955	LOCKWASHER 1/2"	8
	304007	HEX NUT 1/2"	8
5	607727	SEALED BRG. 1" Sq.	4
6	930254	BRG. HANGER	4
7	930264	LONG SPACER 7-1/4" Long	4
8	930256	C.O. DISC 14"	10
9	401033	AXLE 1" Sq. X 46-3/4"	2
10	930259	U-BOLT 1/2" X 3"	4
	304007	HEX NUT 1/2"	8
	303955	LOCKWASHER 1/2"	8

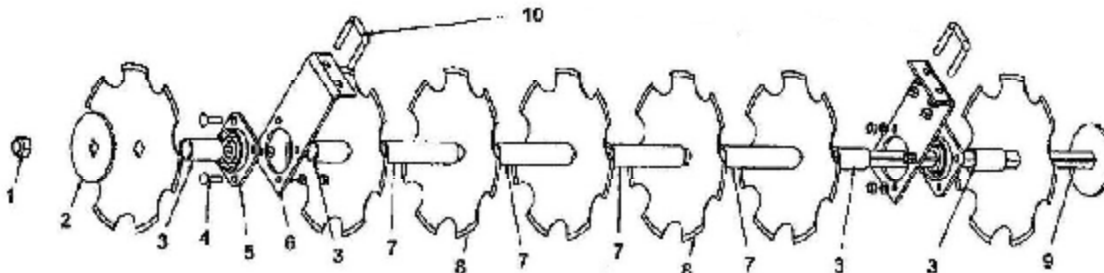

ATV-FLIP OVER DISC HARROW COMPONENTS

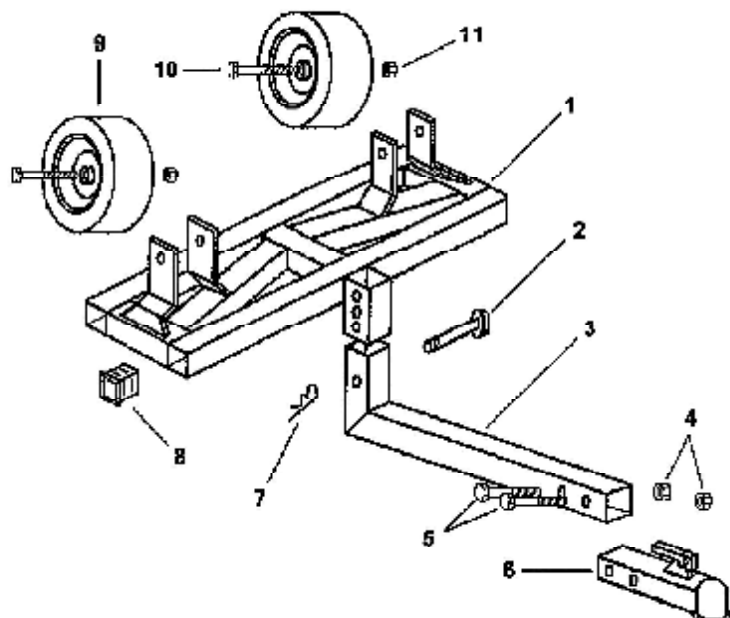

Item	Part #	Description	Qty
1	403890	COMPLETE SHELL	1
2	194110	FIXED HANDLE HITCH PIN	1
3	403891	FLIP OVER TONGUE	1
4	304018	LOCKNUT 3/8"	2
5	303620	HH BOLT 3/8" X 3"	2
6	195168	HITCH - 1-7/8" BALL	1
7	304244	HAIRPIN-COTTER 3/16"	1
8	607616	3" PLASTIC CAP	4
9	930260	TIRE/WHEEL PNUE. 11 X 4	2
10	303710	HH BOLT 3/4" X 6-1/2"	2
11	304022	LOCKNUT 3/4"	2

MAIN FRAME COMPONENTS

Item	Part #	Description	Qty
1	304024	LOCKNUT 1"	2
2	607821	WASHER/NUT 1-5/16" LONG	2
3	607705	16" CUT OUT DISC BLADE	8
4	607818	CAST SPACER 2-3/8" LONG	4
5	303889	CARRIAGE BOLT 1/2" X 1-1/2"	16
6	607819	CAST SPACER 3-5/8" LONG	4
7	607617	CAST SPACER 7"	2
8	607624	BRG. DHU ST208-1 N	4
9	607620	BUMPER WASHER	2
10	930264	BRG. HANGER	4
11	607615	U-BOLT 5/8" X 4-1/2"	4
12	607728	AXLE 1" X 1" X 28-3/4"	2
13	360509	AXLE BUSHING 1-1/4" O.D. X 1/2"	4

DISC GANG COMPONENTS

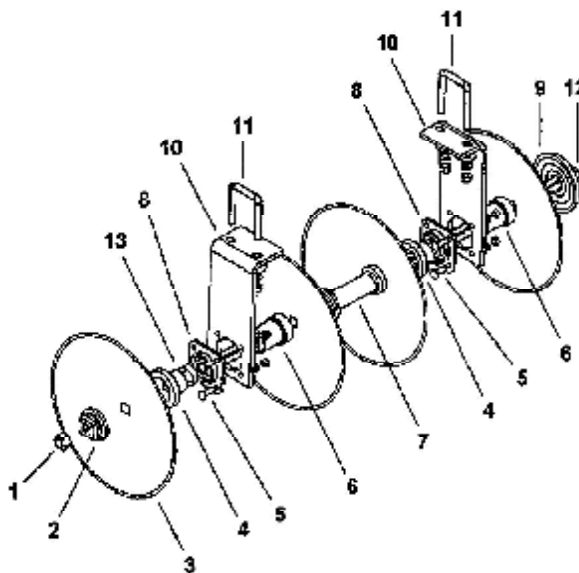

CULTI-PACKER COMPONENTS

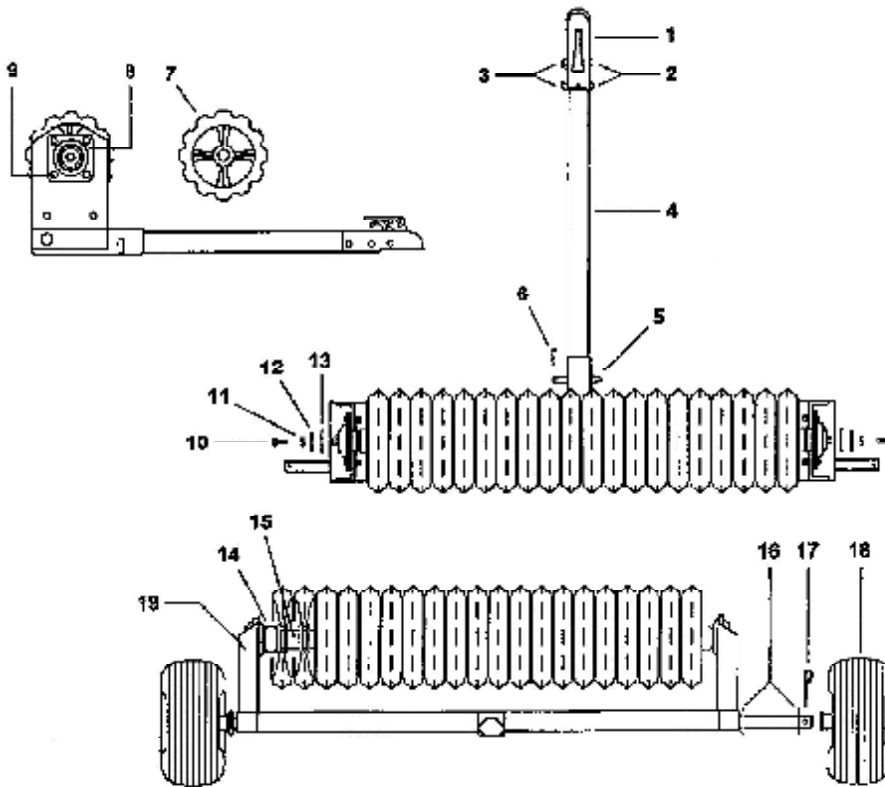

Item	Part #	Description	Qty
1	171028	HITCH - 1-7/8" BALL	1
2	303620	HH BOLT 3/8" X 3"	2
3	304018	LOCKNUT 3/8"-NC	2
4	380607	TONGUE	1
5	194102	PIN 5/8" X 3"	1
6	304244	HAIRPIN COTTER 3/16"	1
7	171021	CULTI-PACKER WHEEL	20
8	171025	SEALED BEARING	2
9	303651	HH BOLT 1/2" X 1-1/2"	8
	303955	LOCKWASHER 1/2"	8
	304007	HEX NUT 1/2"	8
10	303651	HH BOLT 1/2" X 1-1/2"	2
11	303955	LOCKWASHER 1/2"	2
12	303972	FLATWASHER 5/8"	2
13	303974	FLATWASHER 7/8"	2
14	380810	SPACER	2
15	380608	BEATER BAR	1
16	303975	FLATWASHER 1"	4
17	304111	COTTER PIN 3/16" X 2"	2
18	171030	TIRE & WHEEL	2
19	403080	FRAME ASSEMBLY	1